



# Maintenance Manual

*MR3*



# General Information

**Thank you for purchasing an Islander MR3 mooching reel.**

In this manual you will find tips and instructions on how to keep your reel functioning like new for years to come. Concise illustrations will help you clean and lubricate each important components.

## **Features of the MR3**

- Full frame construction with one-piece spool and frame.
- Large arbor, ultra-light spool with ventilated arbor. The large arbor allows for two to three times the retrieval rate of a standard arbor.
- A huge 2-7/16" drag surface using Islander's proven graphite impregnated cork material. This, coupled with a dual phosphor bronze pawl system, produces incredible stopping power.
- Converts from right to left-hand retrieve in seconds.
- Large, contoured palming rim and handles.
- Buttery smooth sealed stainless steel bearings.
- Large sculpted drag knob.

## **Technical Support**

Telephone 1-250-544-4856

E-Mail [info@islander.com](mailto:info@islander.com)

# Major Components

Clicker Assembly

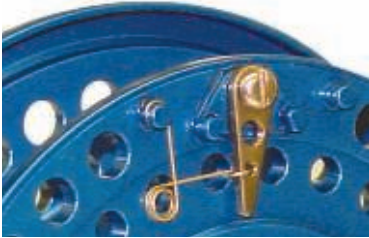

Clutch Assembly

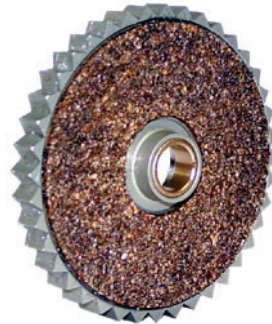

Bearing

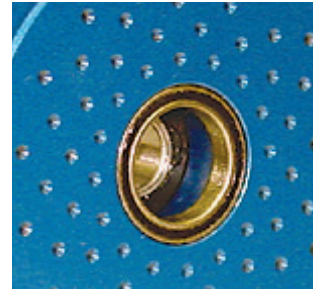

Pawl Assembly

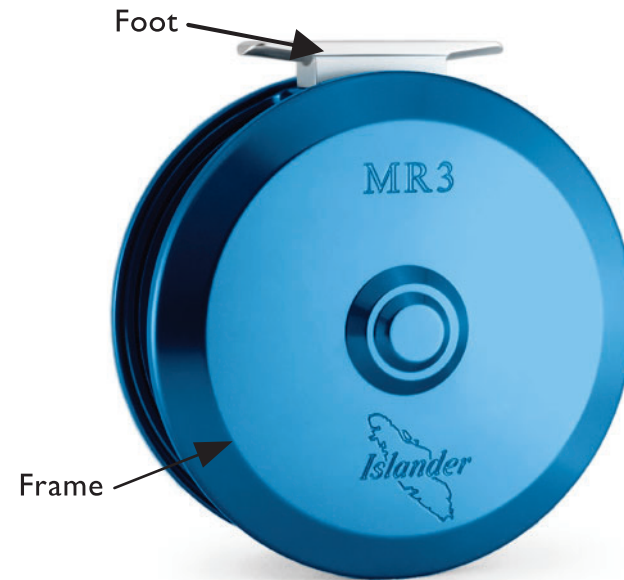
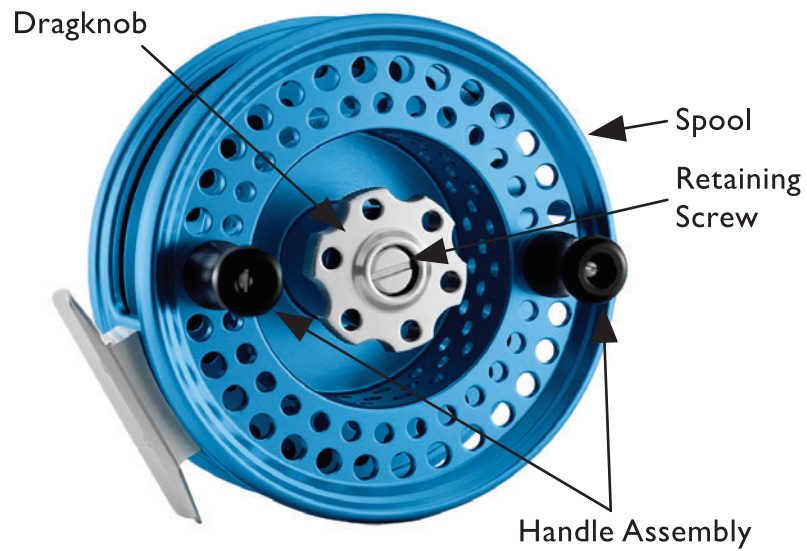

## How To Disassemble Your Reel

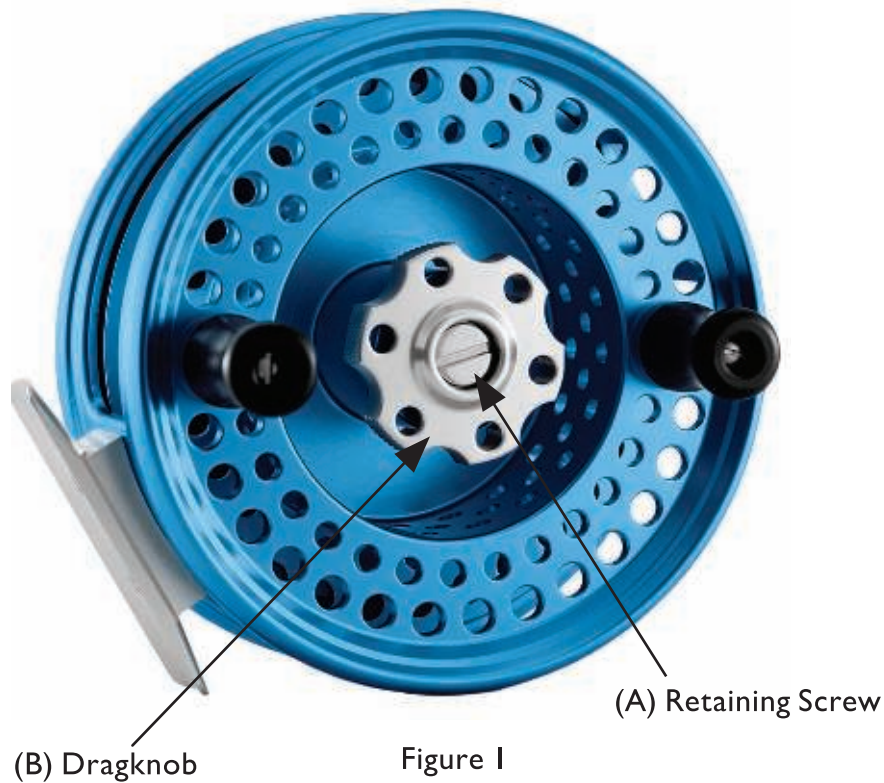

1. Remove the spindle screw by turning it counter-clockwise with a flat bladed screw driver.
2. Remove the dragknob by hand, turning it counter-clockwise until you can remove it.  
Underneath the dragknob there will be a stainless steel washer. It will either be stuck to the bottom of the dragknob or to the top of the dragspring.
3. Grasp the outside of the frame with one hand and the spool with the other, and pull the frame and spool apart.

At this point there should be 6 free assemblies: Retaining Screw, Dragknob, Dragknob Washer, Dragspring, Spool, and Frame.

Reassembly is the opposite of disassembly. When you are reinstalling the drag knob, make sure the stainless steel washer is under the drag knob and not under the dragspring.

# Cleaning and Lubricating Your Reel

Your reel comes from the factory lubricated. Periodic lubrication is recommended to maintain optimum performance.

**1. Frame Assembly** and Foot / Reel Seat - Rinse and dry after use.

2. Pawl Assemblies - Remove old oil and any grit. Apply a drop of oil around the springs and pawl.

3. Spindle - Remove all the old lubricant and any grit from the spindle and apply a small amount of grease to the base of the spindle.

4. Clutch Surface - Wipe cork surface to remove excess oil and graphite. Apply a small amount of oil and powdered graphite to the cork surface and work it in with your finger.

5. Clutch Assembly - Remove old grease and any grit from the bearing, inside and out. Apply a small amount of grease to the bearing. Remove old grease from between the teeth of the clutch. Apply a small amount of grease between the teeth.

6. Spindle O-Ring - Remove old grease and any grit prior to clutch installation.

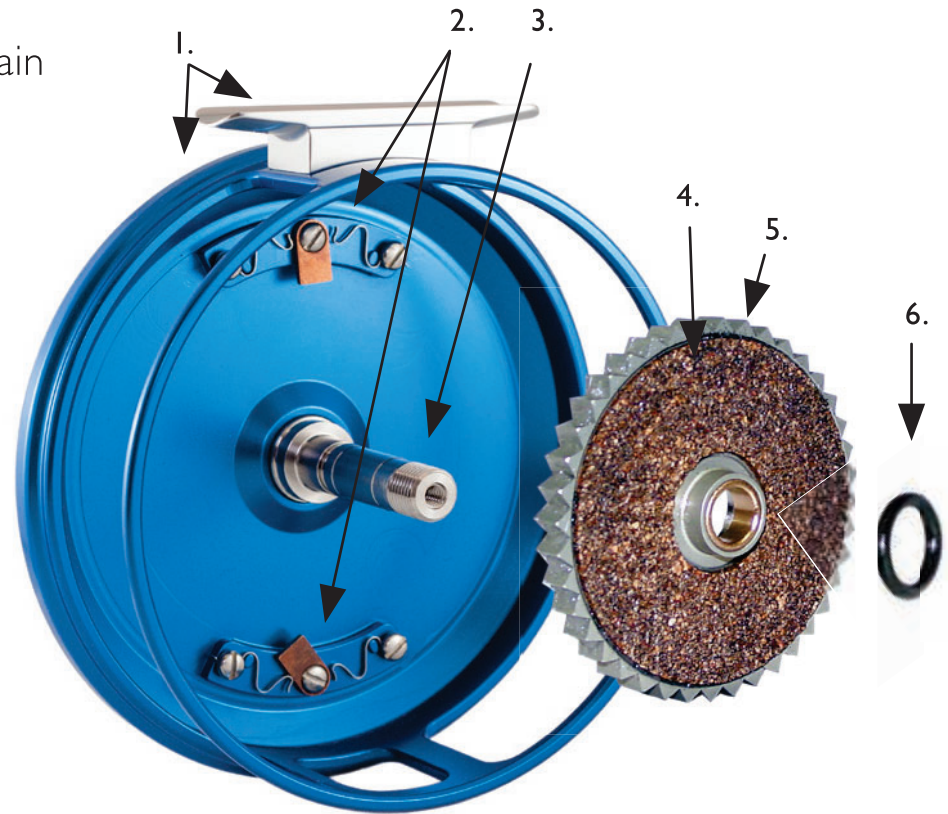

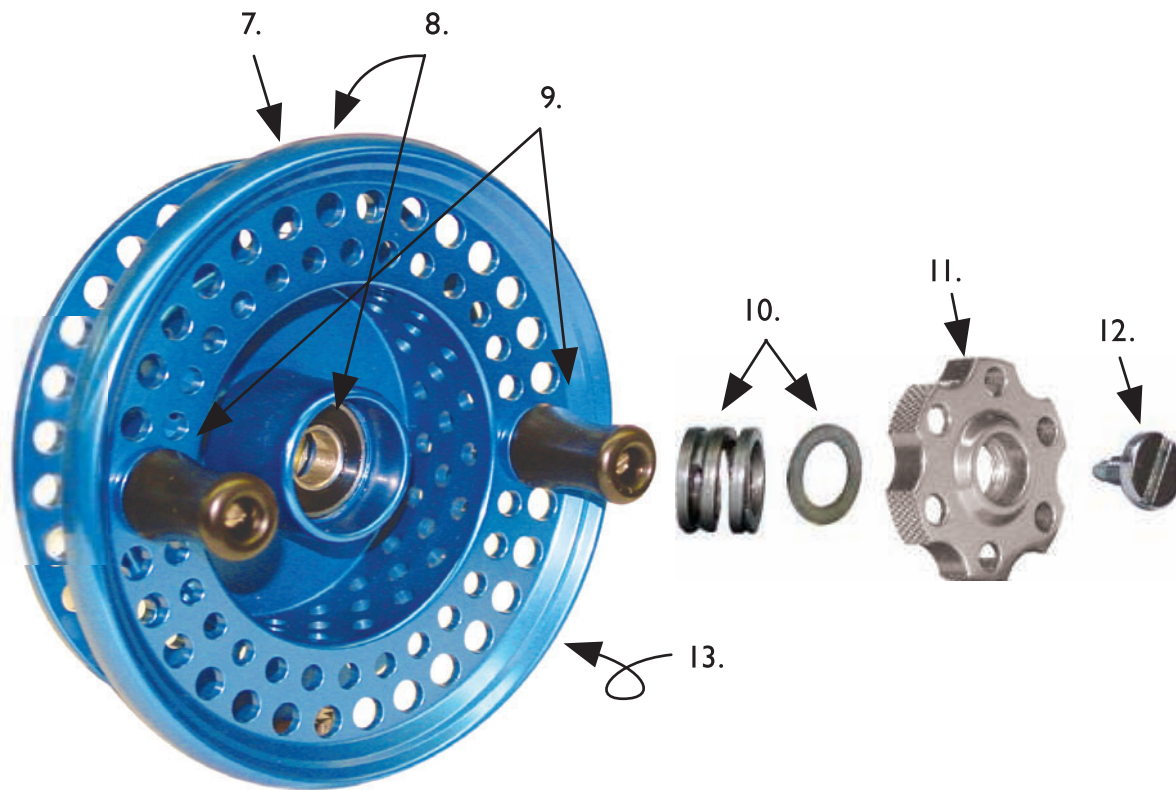

*This level of cleaning or lubrication should be carried out once every 3-4 fishing trips. Because of saltwater conditions, it is important that the reel be rinsed off under a warm water stream after each trip. While the reel is saltwater safe, the quick rinse will help your reel perform better in the long run. Avoid immersing the spool in water, because moisture will be retained by the backing and line.*

**7. Spool Assembly** - Rinse and dry after use.

8. Front and Rear Spool Bearings - Remove old grease and grit with a dry cloth. Apply a small amount of grease to the exposed bearing shields.

9. Handle Assemblies - If the handles start to stick, you can remove the handle from the base by undoing the handle screw and remove any grit. No lubrication is required.

10. Dragspring and Drag Knob Washer - Remove old grease and any grit.

11. Drag Knob - Remove old grease and any grit. Clean center threads using a cotton swab or a small cloth. Apply a small amount of grease to the inside threads.

12. Spindle Screw - Remove old grease and any grit. Apply a very small amount of grease around the threads.

13. Clicker Assembly - Remove old oil and any grit. Apply a drop of oil through each hole on the clicker, around the screw head and around the clicker spring.

## Retrieve Conversion (Right & Left-Hand)

1. Disassemble your reel.
2. Remove the spindle O-Ring (see exploded view).
3. Lift the Clutch Assembly (see exploded view).
4. Arrange the pawl direction as per Fig. 3 or Fig. 4.
5. Replace Clutch Assembly and Spindle O-Ring.
6. Reassemble your reel.



Figure 2  
Left-Hand Retrieve



Figure 3  
Right-Hand Retrieve

## Tuning

*It's possible to tune the outgoing click (somewhat). For these adjustments, you will need to disassemble your reel.*

1. To make the outgoing click louder, push the clicker spring in the direction shown by [A], Figure 4. Push the spring until the clicker [1] is pointing directly at the bearing on the rear of the spool.
2. To make the outgoing click softer, push the clicker spring [2] in the direction shown by [B], Figure 4. Do not push spring more than a few degrees, as pushing too far will disengage the clicker.

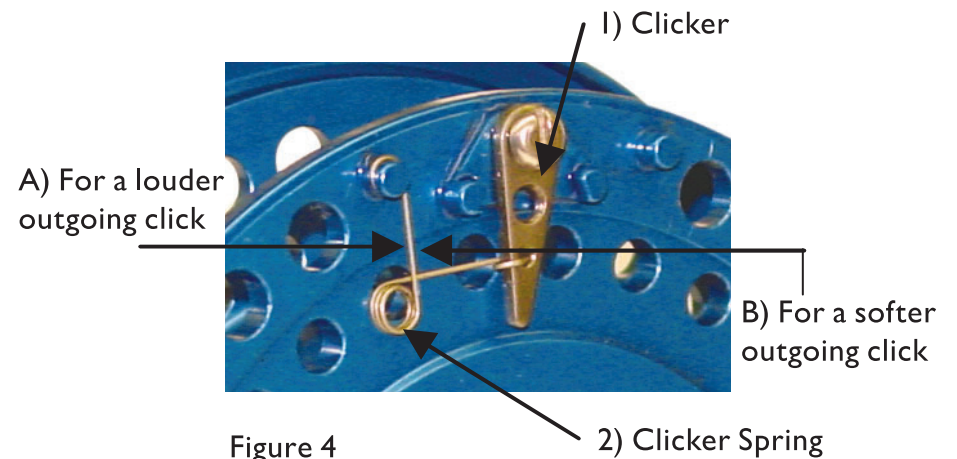
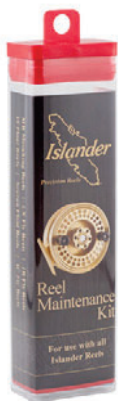

Figure 4



[info@islander.com](mailto:info@islander.com) | [www.islander.com](http://www.islander.com)



### Reel Maintenance Kit

Use the same lubricant as the pros! A well lubricated and clean reel will last you a lifetime. We recommend Islander's Reel Maintenance Kit. It comes with all the lubricants you need for your MR3 reel.

Oil: Super Lube® Multi-Purpose Synthetic-based Oil with PTFE®  
Grease: Super Lube® Multi-Purpose Lubricant with Teflon®

Contact your local dealer or visit [www.islander.com](http://www.islander.com).

**Copyright © 2017 Islander Precision Reels. All Rights Reserved.**

Specifications and information contained in this manual are furnished for informational use only, and are subject to change at any time without notice.

Products and corporate names appearing in this manual may or may not be registered trademarks or copyrights of their respective companies, and are used only for identification or explanation and to the owners' benefit, without the intent to infringe.